

KCB 2CY YCB型

KCB 2CY YCB系列轮齿泵

(KCB 2CY YCB齿轮泵)

Use Specification | 使用说明书



上海新光明泵业制造有限公司

地址：上海市武定路576号 电话：021-62586878/ 62583382

传真：021-62156276 邮编：200040

KCB 系列齿轮泵

KCB SERIES GEAR PUMP

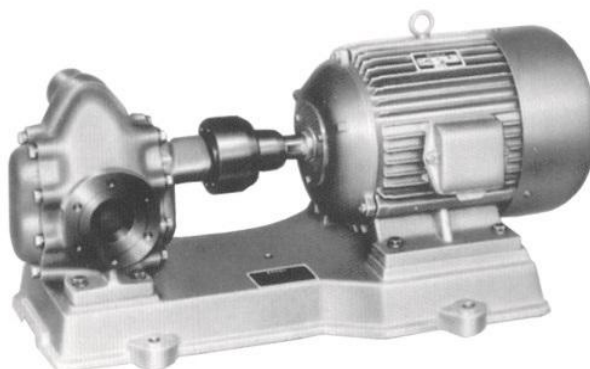

1、用途

适用于输送不含固体颗粒和纤维，温度不高于300℃，粘度为 $5 \times 10^{-6} \sim 1.5 \times 10^{-3} \text{m}^2/\text{s}$ (5—1500cSt)的润滑油或性质类似润滑油的其它液体。

降低泵的转速，输送介质的粘度可到 $5 \times 10^4 \text{cSt}$ 。

2、应用范围

在输油系统中可用作传输、增压泵；
在燃油系统中可用作输送、加压、喷射的燃油泵；
在一切工业领域中，均可作润滑油泵用。

3、结构特点

本系列齿轮泵主要有齿轮、轴、泵体、安全阀、轴端密封（特殊要求，可选用磁力驱动，零泄漏结构）等组成。齿轮经热处理有较高的硬度和强度，与轴一同安装在可更换的轴套内运转。泵内全部零件的润滑均在泵工作时利用输送介质而自动达到。

泵内有设计合理的泄油槽和回油槽，使齿轮在工作中承受的扭矩力最小，因此轴承负荷小，磨损小，泵效率高。

泵设有安全阀作为超载保护，安全阀的全回流压力为泵额定排出压力的1.5倍，也可在允许排出压力范围内根据实际需要另外调整。但注意本安全阀不能作减压阀长期工作，必要时可在管路上另行安装。

从主轴外伸端向泵看，为顺时针旋转。

1、Application:

It applies to delivering non-corrosive lubricating-oil or equivalent liquid without solid particles and fibres at temperature below 300℃ and with the viscosity of $5 \times 10^{-6} \sim 1.5 \times 10^{-3} \text{m}^2/\text{s}$ (5—1500cSt).

Reducing the speed, the pump can delivery the liquid that the viscosity can be up to $5 \times 10^4 \text{cSt}$.

2、Application Scope

It can give performance as transfer pump or booster pump in oil delivery system. It can be also applied as fuel pump for delivery system, pressurization and injection in fuel supply system and in all industry fields as lubricating pump.

3、Structure Features

KCB series gear pumps are mainly composed of gears, axles, pump body, pump cover, safety valve and axle-end seals etc. (Speical requirement, magnetic force drive and zero-leakage structure can be selected.) The heat-treated gears have the advantage of higher hardness and intensity, and rotate with the axles inside the replaceable bearing sleeves. All of pump's parts can be lubricated by delivered medium when working.

The pump is properly designed with leakage and return chute, which lets the gears bear the least torque force and reduces load and wear on bearings in order to raise pump's efficiency.

It is also designed with safty valve for protection against overload. The full return flow pressure of the safety valve is 1.5 times higher than the rated exhaust pressure of the pump. It can be also adjusted within the allowance of exhaust pressure range according to circumstances. But please note the safty valve can't be applied as pressurereducing valve for long time. You may install pressurereducing valve separately on pipe-line if needed.

The direction of rotation is clockwise viewed from coupling end.

2CY 系列齿轮泵

2CY SERIES GEAR PUMP

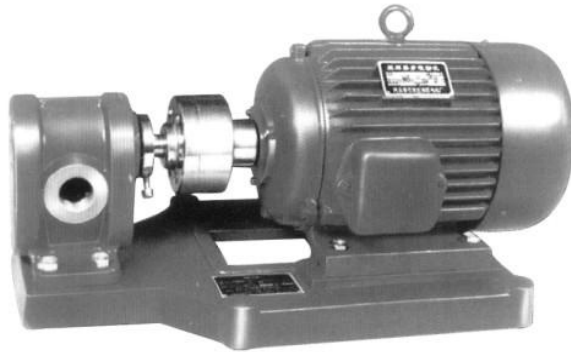

1、用途

适用于输送不含固体颗粒和纤维，温度不高于300℃，粘度为 $5 \times 10^{-6} \sim 1.5 \times 10^{-3} \text{m}^2/\text{s}$ (5—1500cSt)的润滑油或性质类似润滑油的其它液体以及用于液压传动系统。

降低泵的转速，输送介质的粘度可到 $5 \times 10^4 \text{cSt}$ 。

2、应用范围

在输油系统中可用作传输，增压泵；

在燃油系统中可用作输送、加压、喷射的燃油泵；

在液压传动系统中可用作提供液压动力的液压泵；

在一切工业领域中，均可作润滑油泵用。

3、结构特点

本系列齿轮泵主要有齿轮、轴、泵体、泵盖、轴承套、轴端密封（特殊要求，可选用磁力驱动，零泄漏结构）等组成。齿轮经氮化处理有较高的硬度和耐磨性。与轴一同安装在可更换的轴套内运转。泵内全部零件的润滑均在泵工作时利用输送介质而自动达到。

泵内四个轴承套在泵体内浮动安装，随工作压力大小自动调整端面间隙，因此泵的压力稳定，输出流量脉动小，容积效率高。

从主轴外伸端向泵看，为顺时针旋转。

1、Application:

It applies to delivering non-corrosive lubricating-oil or equivalent liquid without solid particles and fibres at temperature below 300℃ and with the viscosity of $5 \times 10^{-6} \sim 1.5 \times 10^{-3} \text{m}^2/\text{s}$ (5—1500cSt). It applies to hydraulic system, too.

Reducing the speed, the pump can delivery the liquid that viscosity can be up to $5 \times 10^4 \text{cSt}$.

2、Application Scope

It can give performance as transfer pump or booster pump in oil delivery system, and fuel pump for delivery, pressurization and injection in fuel supply system. It can be also applied as hydraulic pump supplying hydraulic power in hydraulic system and in all industry fields as lubricating pump.

3、Structure Features

2CY series gear pumps are mainly composed of gears, axles, pump body, pump cover, bearing sleeves and axle-end seals, etc. (Special requirement, magnetic force drive and zero-leakage structure can be selected.) The nitriding-treated gears have the advantage of higher hardness and wear property, and they rotate with the axles inside the replaceable bearing sleeves. All of pump's parts can be lubricated by delivered medium when working.

Four bearing sleeves are installed suspended in pump body and can be automatically adjusted with facing gaps clearance complying with pressure change, therefore, it results in stable pump pressure, little discharge, flow pulsation and higher volume efficiency.

The direction of rotation is clockwise viewed from coupling end.

YCB 系列圆弧齿轮泵

YCB SERIES CIRCULAR GEAR PUMP

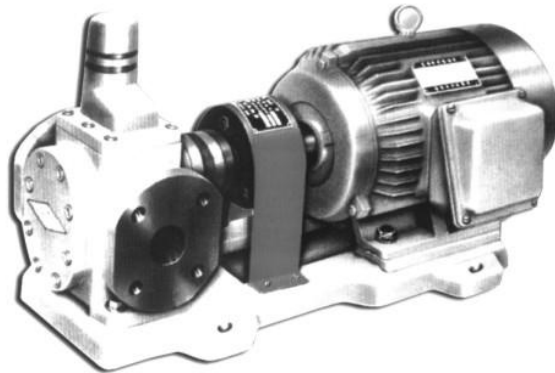

1、用途

适用于输送不含固体颗粒和纤维，无腐蚀性，温度不高于300℃，粘度为 $5 \times 10^{-6} \sim 1.5 \times 10^{-3} \text{m}^2/\text{s}$ (5—1500cSt) 的润滑油或性质类似润滑油的其它液体以及用于液压传动系统。

降低泵的转速，输送介质的粘度可到 $5 \times 10^4 \text{cSt}$ 。

2、应用范围

在输油系统中可用作传输，增压泵；

在燃油系统中可用作输送、加压、喷射的燃油泵；

在液压传动系统中可用作提供液压动力的液压泵；

在一切工业领域中，均可作润滑油泵用。

3、结构特点

本系列齿轮泵主要有齿轮、轴、泵体、泵盖、轴承套、轴端密封（特殊要求，可选用磁力驱动，零泄漏结构）等组成。齿轮采用双圆弧正弦曲线齿形制造。它与渐开线齿轮相比最突出的优点是齿轮啮合过程中齿廓面没有相对滑动，所以齿面无磨损，运转平稳，无困液现象，噪音低、寿命长、效率高。该泵摆脱了传统设计的束缚，使得齿轮泵在设计、生产和使用上进入了一个新的领域。

泵设有安全阀作为超载保护，安全阀全回流压力为泵额定排出压力的1.5倍，也可在允许排出压力范围内根据实际需要另行调整。但注意本安全阀不能作减压阀长期工作，需要时可在管路上另行安装。

泵轴端密封设计为两种形式，一种为机械密封，一种是填料密封，可根据具体使用情况和用户要求确定。

从主轴外伸端向泵看，为顺时针旋转。

1、Application:

It applies to delivering non-corrosive lubricating-oil or equivalent liquid without solid particles and fibres at temperature below 300℃ and with the viscosity of $5 \times 10^{-6} \sim 1.5 \times 10^{-3} \text{m}^2/\text{s}$ (5—1500cSt). It applies to hydraulic System, too.

Reducing the speed, the pump can delivery the liquid that viscosity can be up to $5 \times 10^4 \text{cSt}$.

2、Application Scope

It can give performance as transfer pump or booster pump in oil delivery system, and fuel pump for delivery, pressurization and injection in fuel supply system. It can be also applied as hydraulic pump supplying hydraulic power in hydraulic system and in all industry fields as lubricating pump.

3、Structure Features

YCB series gear pumps are mainly composed of gears, axles, pump body, pump cover, safety valve and axle-end seals etc. (Special requirement, magnetic force drive and zero-leakage structure can be selected.) The gears are adopted double circular teeth shape, which makes the gears less wear on gear surface, stable revolution, low noise, long service life and high efficiency, due to no sliding on the teeth during gear falling-in. This kind of pump has got rid of traditional design and come into a new decade in designing and application.

The pump is designed with safety valve for protection against overload. The full return flow pressure is 1.5 times higher than the rated exhaust pressure of the pump. It can be adjusted within the allowance of exhaust pressure range according to circumstance. But please note the safety valve can't be applied as pressure-reducing valve for long time. You may install pressure-reducing valve separately on pipe-line if needed.

There are two kinds of axle-end seals, mechanical seal and packing seal, which can be chosen according to the clients' requirement or application circumstance.

The direction of rotation is clockwise viewed from coupling end.

4、性能曲线图

各型齿轮泵的性能参数，是在介质粘度 $4 \times 10^{-5} \text{m}^2/\text{s}$ (40cSt) 时确定的。性能参数表中给出的参数值适用于介质粘度 $1 \times 10^{-5} \sim 8 \times 10^{-5} \text{m}^2/\text{s}$ (10—80cSt) 范围内，超出这个范围则根据用户提出的性能参数要求另行确定。

各型齿轮泵性能参数中给出的排出压力是给出的最大工作压力值，在此范围内泵均能正常工作，其工作范围见图一。

4、Diagram of performance curve:

Performance data of all gear pumps have been defined on basis of the viscosity of $4 \times 10^{-5} \text{m}^2/\text{s}$ (40cSt). The data indicated in the performance diagram is suitable to medium viscosity of $1 \times 10^{-5} \sim 8 \times 10^{-5} \text{m}^2/\text{s}$ (10—80cSt). If which exceeds the above viscosity, the data will be re-defined according to the client's demands.

The given exhausting pressure of all gear pumps is the highest working pressure, and pumps can perform normally within range of the rated working pressure, which can be found in Diagram NO.1.

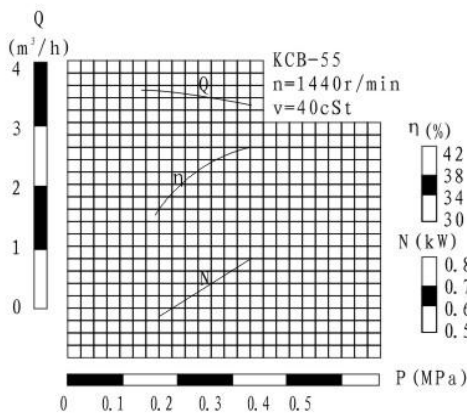

KCB-55型性能曲线图

Diagram of Performance Curve of Model KCB-55 Gear Pump

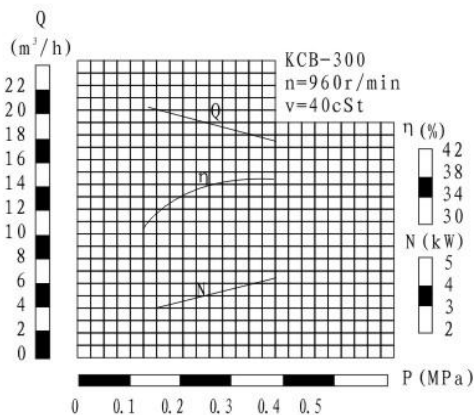

KCB-300型性能曲线图

Diagram of Performance Curve of Model KCB-300 Gear Pump

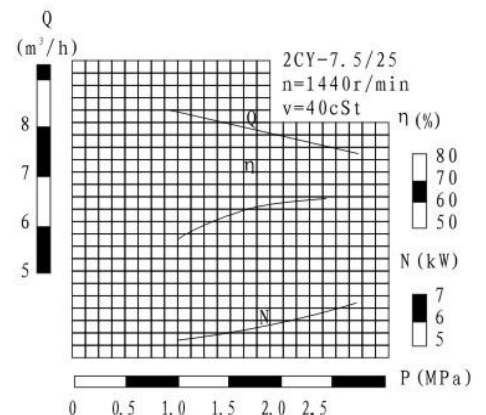

2CY-7.5/25型性能曲线图

Diagram of Performance Curve of Model 2CY-7.5/25 Gear Pump

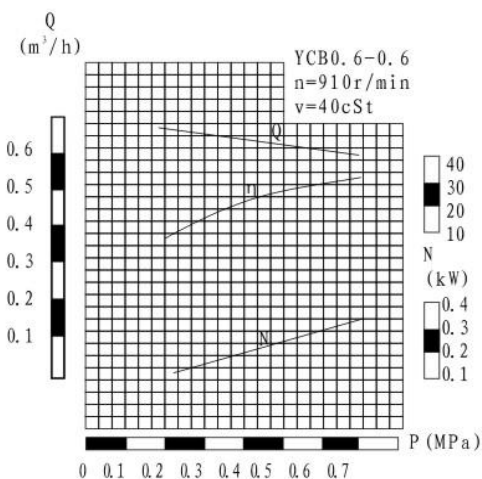

YCB 0.6-0.6型性能曲线图

Diagram of Performance Curve of Model YCB 0.6-0.6 Gear Pump

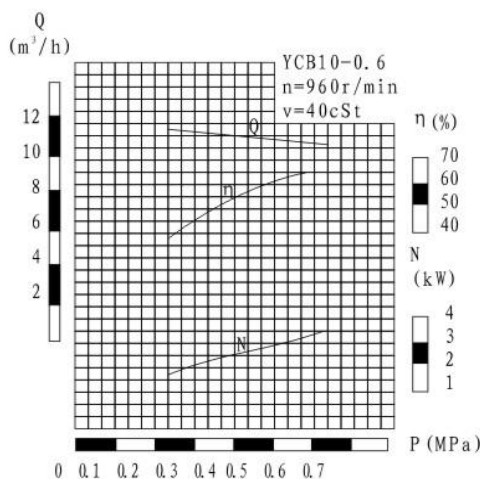

YCB 10-0.6型性能曲线图

Diagram of Performance Curve of Model YCB 10-0.6 Gear Pump

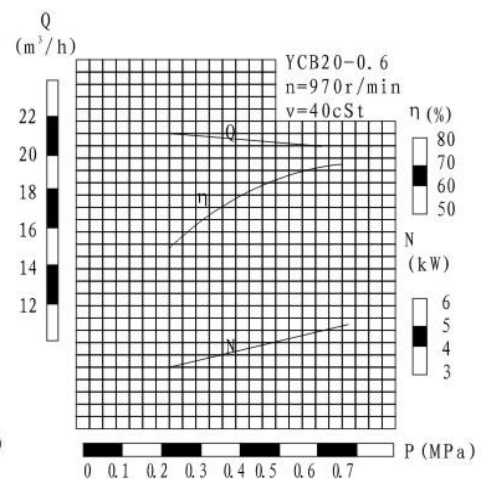

YCB 20-0.6型性能曲线图

Diagram of Performance Curve of Model YCB 20-0.6 Gear Pump

工作范围图(图一) WORKING SCOPE (DIAGRAM NO. 1)

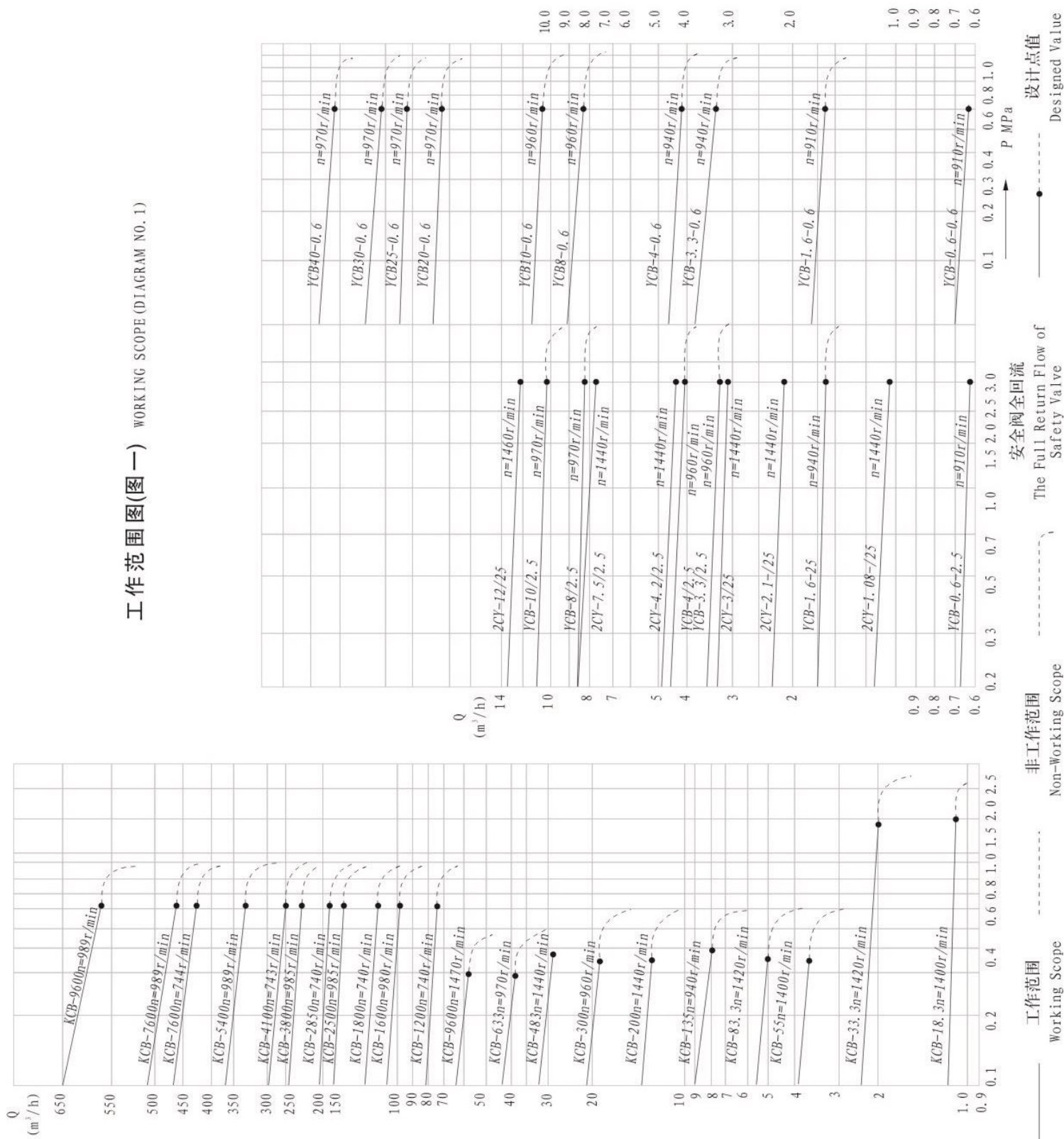

KCB型齿轮泵性能参数 FUNCTIONAL DATA OF KCB SERIES GEAR PUMPS

型号 Model	流量 Capacity Q		转速 Speed n r/min	排出压力 Exhaust Pressure P MPa	必需汽 蚀余量 NPSHR m	效率 Efficiency η %	电动机 Motor	
	m ³ /h	L/min					功率kW Power	型号 Model
KCB-18.3	1.1	18.3	1400	1.45	5	59	1.5	Y90L-4
2CY-1.1/1.45								
KCB-33.3	2	33.3	1420	1.45	5	59	2.2	Y100L1-4
2CY-2/1.45								
KCB-55	3.3	55	1400	0.33	7	41	1.5	Y90L-4
2CY-3.3/0.33								
KCB-83.3	5	83.3	1420	0.33	7	43	2.2	Y100L1-4
2CY-5/0.33								
KCB-135	8	135	940	0.33	5	46	2.2	Y112M-6
2CY-8/0.33								
KCB-200	12	200	1440	0.33	5	46	4	Y112M-4
2CY-12/0.33								
KCB-300	18	300	960	0.36	5	42	5.5	Y132M2-6
2CY-18/0.36								
KCB-483.3	29	483.3	1440	0.36	5.5	42	11	Y160M-4
2CY-29/0.36								
KCB-633	38	633	970	0.28	6	43	11	Y160L-6
2CY-38/0.28								
KCB-960	58	960	1470	0.28	6.5	43	22	Y180L-4
2CY-58/0.28								
KCB-1200	72	1200	740	0.6	7	43	37	Y280S-8
KCB-1600	96	1600	980				45	Y280S-6
KCB-1800	108	1800	740	0.6	7.5	43	55	Y315S-8
KCB-2500	150	2500	985				75	Y315S-6
KCB-2850	171	2850	740	0.6	8	44	90	Y315L1-8
KCB-3800	228	3800	989				110	Y315L1-6
KCB-4100	246	4100	743	0.6	8	44	132	Y355M1-8
KCB-5400	324	5400	989				160	Y355M1-6
KCB-5600	336	5600	744	0.6	8	44	160	Y355M2-8
KCB-7600	456	7600	989				200	Y355M3-6
KCB-7000	420	7000	744	0.6	8	44	185	Y355L1-8
KCB-9600	576	9600	989				250	Y355L2-6

2CY型齿轮泵性能参数 FUNCTIONAL DATA OF 2CY SERIES GEAR PUMPS

型号 Model	流量 Capacity Q		转速 Speed n r/min	排出压力 Exhaust Pressure P MPa	必需汽 蚀余量 NPSHR m	效率 Efficiency η %	电动机 Motor	
	m ³ /h	L/min					功率kW Power	型号 Model
2CY-1.08/2.5	1.08	18	1420	2.5	5.5	58	2.2	Y100L1-4
2CY-2.1/2.5	2.1	35	1420	2.5	5.5	58	3	Y100L2-4
2CY-3/2.5	3	50	1440	2.5	5.5	59	4	Y112M-4
2CY-4.2/2.5	4.2	70	1440	2.5	5.5	62	5.5	Y132S-4
2CY-7.5/2.5	7.5	125	1440	2.5	5.5	63	7.5	Y132M-4
2CY-12/2.5	12	200	1460	2.5	5.5	61	15	Y160L-4
2CY-21/2.5	21	350	1440	2.5	5.5	60	30	Y200L-4

YCB型齿轮泵性能参数

FUNCTIONAL DATA OF YCB SERIES CIRCULAR TEETH GEAR PUMPS

型号 Model	流量 Capacity Q m ³ /h	转速 Speed n r/min	排出压力 Exhaust Pressure P MPa	必需汽 蚀余量 NPSHR m	效率 Efficiency η %	电动机 Motor		
						频率 Hz	功率kW Power	型号 Model
YCB0.6-0.6	0.6	910	0.6	5.5	60	50	0.75	Y90S-6
	1.0	1390				50	0.75	Y80L2-4
	0.7	1130				60	0.75	Y90S-6
	1.2	1710				60	0.75	Y80L2-4
YCB0.6-1.6	0.6	910	1.6	7.0	70	50	1.1	Y90L-6
	1.0	1400				50	1.5	Y90L-4
	0.7	1130				60	1.1	Y90L-6
	1.2	1710				60	1.1	Y90S-4
YCB1.6-0.6	1.6	910	0.6	5.5	63	50	0.75	Y90S-6
	2.5	1400				50	1.1	Y90S-4
	1.9	1130				60	1.1	Y90L-6
	3.0	1710				60	1.5	Y90L-4
YCB1.6-1.6	1.6	940	1.6	7.0	71	50	2.2	Y112M-6
	2.5	1440				50	4	Y112M-4
	1.9	1150				60	2.2	Y112M-6
	3.0	1750				60	4	Y112M-4
YCB3.3-0.6	3.3	940	0.6	5.0	60	50	1.5	YI00L-6
	5.0	1420				50	2.2	YI00L1-4
	4.0	1150				60	1.5	YI00L-6
	6.0	1730				60	2.2	YI00L1-4
YCB3.3-1.6	3.3	960	1.6	7.0	72	50	5.5	Y132M2-6
	5.0	1440				50	7.5	Y132M-4
	4.0	1170				60	4	Y132M1-6
	6.0	1750				60	7.5	Y132M-4
YCB4-0.6	4.0	940	0.6	5.0	60	50	1.5	YI00L-6
	6.0	1420				50	2.2	YI00L1-4
	4.8	1150				60	2.2	Y112M-6
	7.2	1730				60	3	YI00L2-4
YCB4-1.6	4.0	960	1.6	7.0	72	50	5.5	Y132M2-6
	6.0	1440				50	7.5	Y132M-4
	4.8	1170				60	5.5	Y132M-6
	7.2	1750				60	7.5	Y132M-4
YCB8-0.6	8.0	960	0.6	5.0	61	50	3	Y132S-6
	12.0	1440				50	5.5	Y132S-4
	9.6	1170				60	4	Y132M1-6
	14.4	1750				60	5.5	Y132S-4
YCB8-1.6	8.0	970	1.6	7.0	75	50	11	Y160L-6
	12.0	1460				50	15	Y160L-4
	9.6	1170				60	11	Y160L-6
	14.4	1760				60	15	Y160L-4
YCB10-0.6	10.0	960	0.6	5.0	62	50	4	Y132M1-6
	15.0	1440				50	5.5	Y132S-4
	12.0	1170				60	5.5	Y132M2-6
	18.0	1750				60	7.5	Y132M-4
YCB10-1.6	10.0	970	1.6	7.0	76	50	11	Y160L-6
	15.0	1470				50	15	Y160L-4
	12.0	1170				60	11	Y160L-6
	18.0	1770				60	18.5	Y180M-4
YCB20-0.6	20.0	970	0.6	5.0	68	50	7.5	Y160M-6
	24.0	1170				60	7.5	Y160M-6
YCB25-0.6	25.0	970	0.6	5.5	69	50	11	Y160L-6
	30.0	1170				60	11	Y160L-6
YCB30-0.6	30.0	970	0.6	5.5	65	50	11	Y160L-6
	36.0	1170				60	11	Y160L-6
YCB40-0.6	40.0	970	0.6	5.5	66	50	15	Y180L-6
	48.0	1180				60	15	Y180L-6
YCB50-0.6	50.0	970	0.6	5.5	66	50	22	Y200L2-6
	60.0	1180				60	22	Y200L2-6
YCB60	60.0	970	1.0	5.5	65	50	30	Y225M-6
	73.0	1180				60	37	Y250M-6
YCB80	80.0	970	0.6	5.5	65	50	22	Y225M-6
	97.0	1180				60	30	Y225M-6

KCB 18.3 ~ 83.3型泵外形、安装尺寸 KCB18.3~83.3 GEAR PUMP APPEARANCE & INSTALLATION DIMENSION

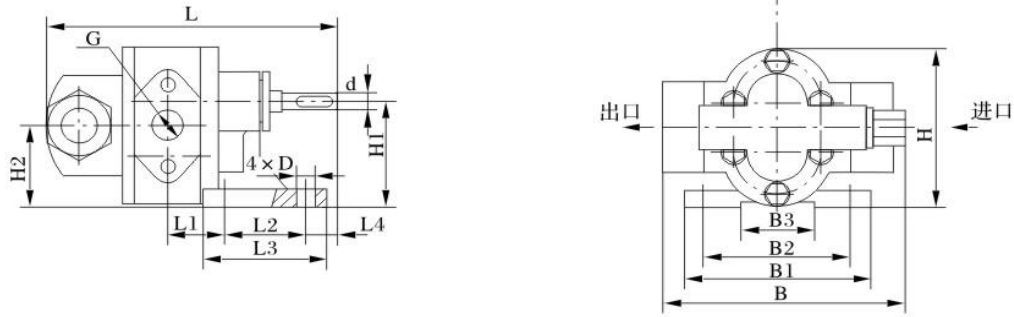

型号 Model	L	L ₁	L ₂	L ₃	L ₄	B	B ₁	B ₂	B ₃	H	H ₁	H ₂	D	d	G
KCB-18.3	217.5	35	80	115	16	192	150	120	66	136	90	69	φ16	φ20	G3/4
KCB-33.3	231	42.5	80	115	16	192	150	120	66	136	90	69	φ16	φ20	G3/4
KCB-55	246	50	80	115	16	192	150	120	66	136	90	69	φ16	φ20	G1
KCB-83.3	271	62	80	115	16	192	150	120	66	136	90	69	φ16	φ20	G1 ^{1/2}

KCB200 ~ 960型泵外形、安装尺寸 KCB200-960 GEAR PUMP OUTLINE & INSTALLATION DIMENSION

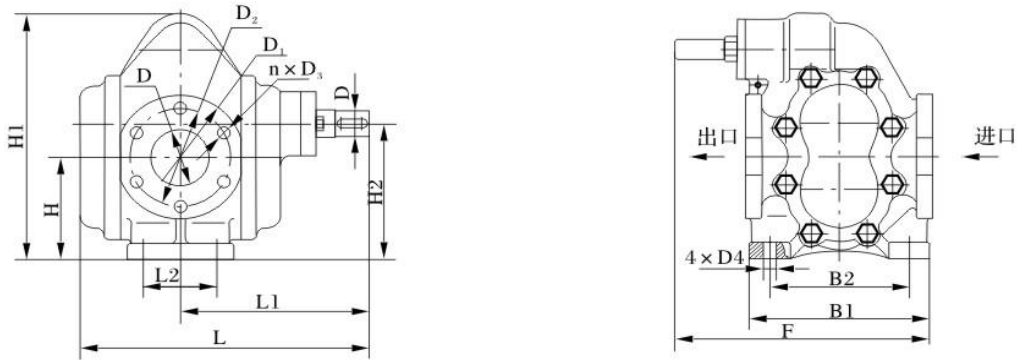

型号 Model	L	L ₁	L ₂	B ₁	B ₂	H	H ₁	H ₂	F	D	D ₁	D ₂	n × D ₃	D ₄	d
KCB-200	290	200	66	214	160	263.5	118	152.5	300	φ50	φ140	φ110	4 × M12	φ13	φ28
KCB-300	354	230	90	228	180	308	128	170	318	φ70	φ155	φ123	6 × M14	φ16	φ32
KCB-483.3	354	230	90	228	180	308	128	170	318	φ70	φ155	φ123	6 × M14	φ16	φ32
KCB-633	415	270	120	280	175	385	188	205	380	φ100	φ190	φ158	8 × M14	φ18	φ38
KCB-960	415	270	120	280	175	385	188	205	380	φ100	φ190	φ158	8 × M14	φ18	φ38

KCB 1200 ~ 9600 型泵外形、安装尺寸 KCB1200-9600 GEAR PUMP OUTLINE & INSTALLATION DIMENSION

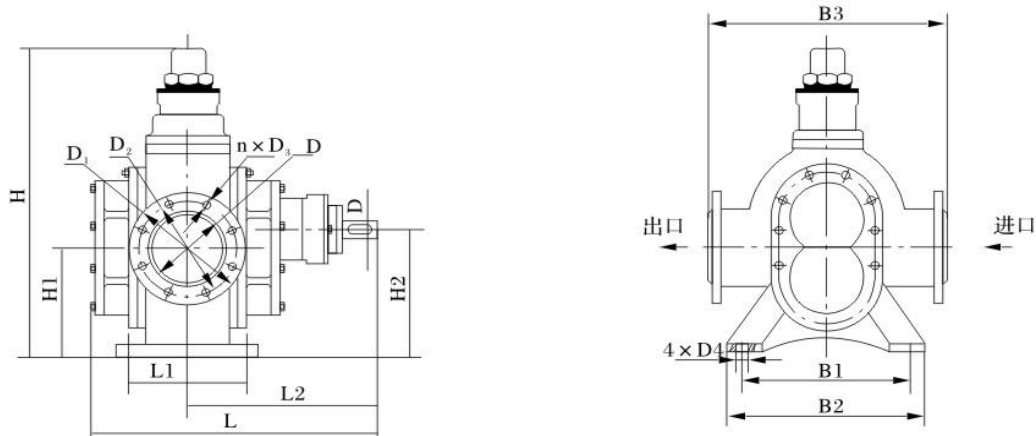

KCB、2CY、YCB 系列齿轮泵

SERIES GEAR PUMP

型号 Model	L	L ₁	L ₂	B ₁	B ₂	B ₃	H	H ₁	H ₂	D	D ₁	D ₂	n×D ₃	D ₄	d
KCB-1200	715	300	480	415	463	510	708	220	300	φ150	φ260	φ225	8×φ18	φ25	φ56
KCB-1600															
KCB-1800															
KCB-2500	830	340	547	460	585	684	876	262	350	φ200	φ320	φ280	8×φ18	φ25	φ76
KCB-2850															
KCB-3800															
KCB-4100	948	380	625	520	584	640	915	299	400	φ250	φ370	φ335	12×φ18	φ25	φ86
KCB-5600															
KCB-7000															
KCB-7600	1085	345	700	500	600	740	1155	386	500	φ350	φ490	φ445	12×φ23	φ32	φ95
KCB-9600															

2CY 型泵外形、安装尺寸 2CY GEAR PUMP OUTLINE & INSTALLATION DIMENSION

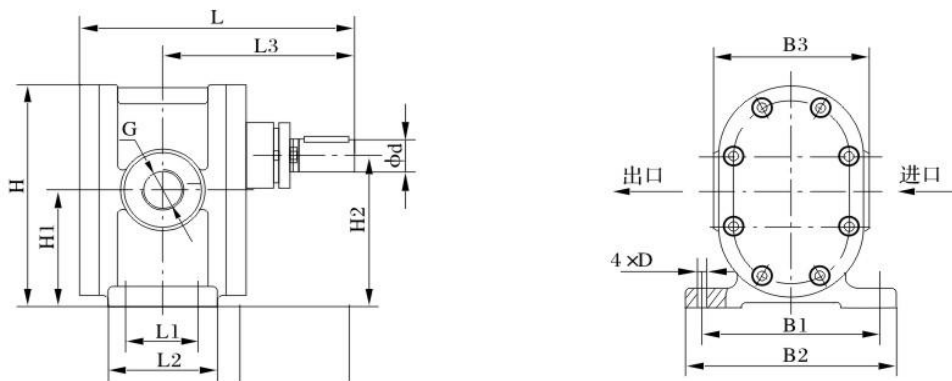

型号 Model	L	L ₁	L ₂	L ₃	B ₁	B ₂	B ₃	H	H ₁	H ₂	D	d	G
2CY-1.08/2.5	193.5	45	75	138.5	114	138	95	132	67.5	87	φ10	φ18	G3/4
2CY-2.1/2.5	198.5	48	78	142.5	124	154	110	164.5	86	112	φ10	φ18	G1
2CY-3/2.5	198.5	48	78	142.5	124	154	110	164.5	86	112	φ10	φ18	G1
2CY-4.2/2.5	220	58	88	155	160	190	140	205	107.5	140	φ12	φ28	G1 1/4
2CY-7.5/2.5	239	65	98	164.5	160	190	140	205	107.5	140	φ12	φ28	G1 1/2
2CY-12/2.5	360	106	136	257	190	220	210	256	136	178	φ14	φ32	G2

YCB 型泵外形、安装尺寸 YCB TYPE GEAR PUMP OUTLINE & INSTALLATION DIMENSION

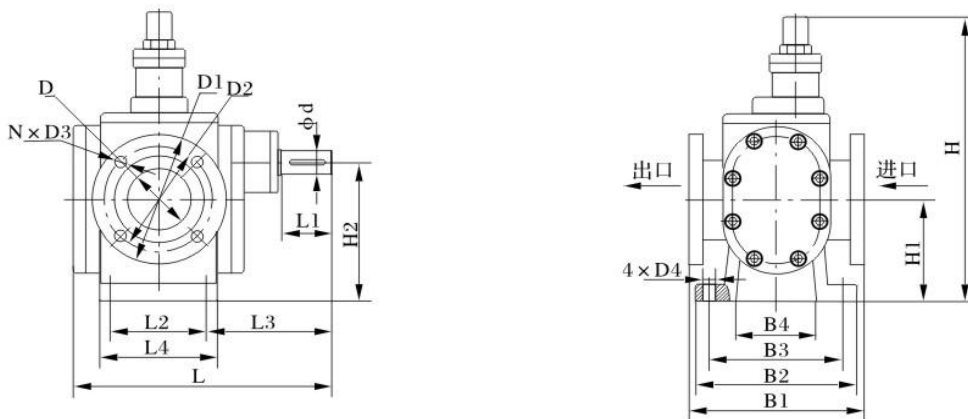

型号 Model	L	L ₁	L ₂	L ₃	L ₄	B	B ₁	B ₂	B ₃	H	H ₁	H ₂	D	D ₁	D ₂	N×D ₃	4×D ₄	d
YCB0.6	180	30	45	107.5	66	125	91	70	35	187	80	92	φ25	φ100	φ75	4×M10	4×φ9	φ12
YCB1.6	208	32	55	118.5	80	150	115	90	50	208	79.7	95	φ32	φ120	φ90	4×φ14	4×φ11	φ14
YCB3.3	247.6	35	70	132.85	98	180	148	120	75	258	87.6	110	φ40	φ130	φ100	4×φ14	4×φ13	φ18
YCB4	260.6	35	80	134.8	108	180	148	120	75	263	92.6	115	φ50	φ140	φ110	4×φ14	4×φ13	φ18
YCB8	313	45	100	158.5	138	220	178	140	90	361	105	135	φ65	φ160	φ130	4×φ14	4×φ13	φ24
YCB10	330	45	100	168.5	138	220	178	140	90	360	105	135	φ65	φ160	φ130	4×φ14	4×φ13	φ24
YCB20	400	55	135	201	182	260	226	180	118	436.5	130.8	170	φ80	φ190	φ150	4×φ18	4×φ18	φ32
YCB25	430	55	135	216	182	260	226	180	118	436.5	130.8	170	φ100	φ210	φ170	4×φ18	4×φ18	φ32
YCB30	459	60	150	236	200	275	231	190	126	461	141	185	φ100	φ210	φ170	4×φ18	4×φ18	φ35
YCB40	500	70	175	251.5	225	300	260	210	140	509	157	205	φ125	φ240	φ200	8×φ18	4×φ18	φ40
YCB50	493	70	175	246.5	225	300	260	210	140	509	157	205	φ125	φ240	φ200	8×φ18	4×φ18	φ40
YCB60	517	80	175	246.5	225	360	260	210	140	562	180	240	φ125	φ250	φ210	8×φ18	4×φ18	φ50

KCB-18.3 ~ KCB-83.3 整机外形、安装尺寸及重量

KCB-18.3 ~ KCB-83.3 GEAR PUMP OUTLINE & INSTALLATION DIMENSION AND WEIGHT

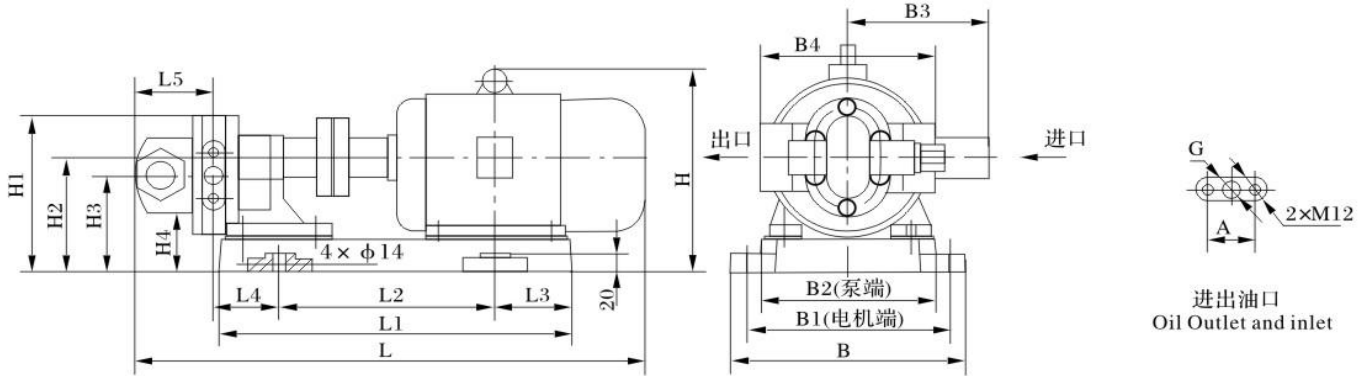

型号 Model	L	L ₁	L ₂	L ₃	L ₄	L ₅	H	H ₁	H ₂	H ₃	H ₄	B	B ₁	B ₂	B ₃	B ₄	A	G	重量 Weight(kg)
KCB-18.3	566	391	239	86	75	86	230	176	130	109	40	259	225	190	155	192	52	G ³ / ₄	62.15
KCB-33.3	618	416	256	94	82	93	285	186	140	119	50	279	245	190	180	192	52	G ³ / ₄	66.8
KCB-55	595	391	239	86	89.5	100.5	230	176	130	109	40	259	225	190	155	192	70	G1	64.15
KCB-83.3	652	416	256	94	102	113	285	186	140	119	50	279	245	190	180	192	78	G1 ¹ / ₂	70.15

KCB-200 ~ KCB-960 整机外形、安装尺寸及重量

KCB-200 ~ KCB-960 GEAR PUMP OUTLINE & INSTALLATION DIMENSION AND WEIGHT

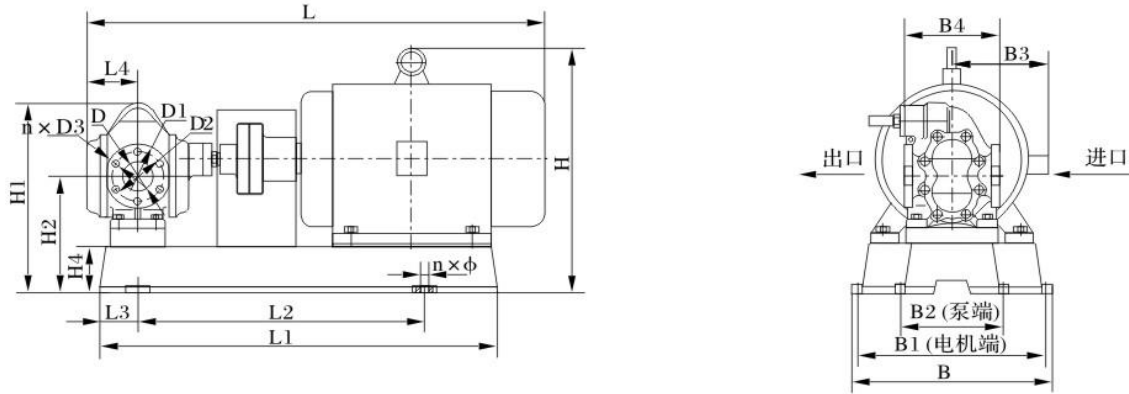

型号 Model	L	L ₁	L ₂	L ₃	L ₄	H	H ₁	H ₂	H ₄	B	B ₁	B ₂	B ₃	B ₄	D	D ₁	D ₂	n × D ₃	n × φ	重量 Weight(kg)
KCB-200	709	577	419	58	90	355	314	168	50	326	290	240	190	214	φ 50	φ 110	φ 140	4 × M12	4 × φ 16	135
KCB-300	883	715	502	80	124	423	378	198	70	390	340	280	210	228	φ 70	φ 123	φ 155	6 × M14	4 × φ 22	173
KCB-483.3	972	795	565	80	124	465	378	198	70	450	400	290	255	228	φ 70	φ 123	φ 155	6 × M14	4 × φ 22	213
KCB-633	1074	901	629	100	145	500	455	258	70	450	400	285	255	280	φ 100	φ 158	φ 190	8 × M14	4 × φ 22	274.5
KCB-960	1099	900	635	100	145	525	455	258	70	470	420	285	285	280	φ 100	φ 158	φ 190	8 × M14	4 × φ 22	304.5

2CY-1.08/2.5~2CY-12/2.5整机外形、安装尺寸及重量

2CY-1.08/2.5~2CY-12/2.5 GEAR PUMP OUTLINE & INSTALLATION DIMENSION AND WEIGHT

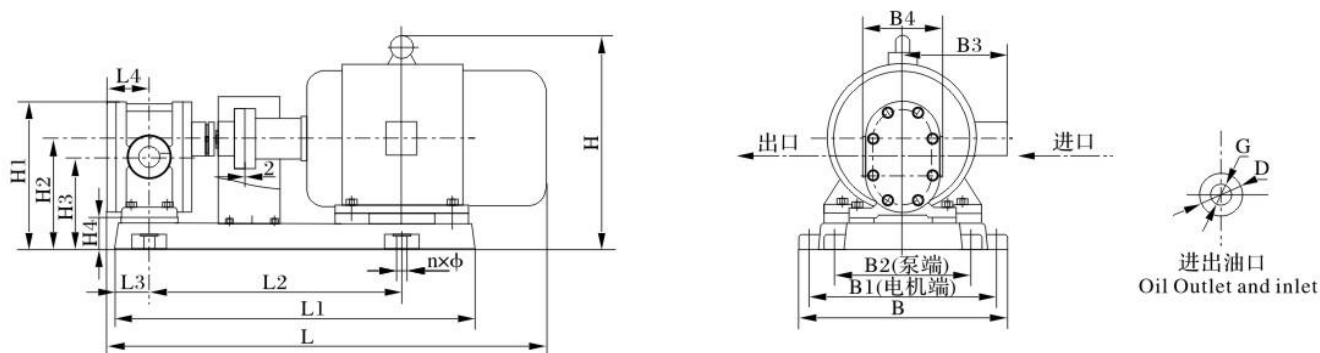

型号 Model	L	L ₁	L ₂	L ₃	L ₄	H	H ₁	H ₂	H ₃	H ₄	B	B ₁	B ₂	B ₃	B ₄	G	D	n × φ	重量 Weight(kg)
2CY-1.08/2.5	582	486	339	47.5	55	290	190	145	125.5	58	293	257	190	180	95	G3/4	φ36	4 × φ18	56
2CY-2.1/2.5	586	493	344	49	56	302	210	157	131	45	293	257	206	180	110	G1	φ50	4 × φ18	63.5
2CY-3/2.5	605	499	349	49	56	310	210	157	131	45	333	297	206	190	110	G1	φ50	4 × φ18	77.5
2CY-4.2/2.5	720	585	420	54	65	373	255	190	157.5	50	368	332	242	210	140	G1 ¹ / ₄	φ70	4 × φ18	121
2CY-7.5/2.5	780	637	448	60	75	378	260	195	162.5	55	368	332	242	210	140	G1 ¹ / ₂	φ70	4 × φ18	136
2CY-12/2.5	1020	862	616	78	103	468	321	243	201	65	416	380	272	255	210	G2	φ95	4 × φ18	173

KCB-1200~KCB-9600整机外形及安装尺寸

KCB-1200~KCB-9600 GEAR PUMP OUTLINE & INSTALLATION DIMENSION AND WEIGHT

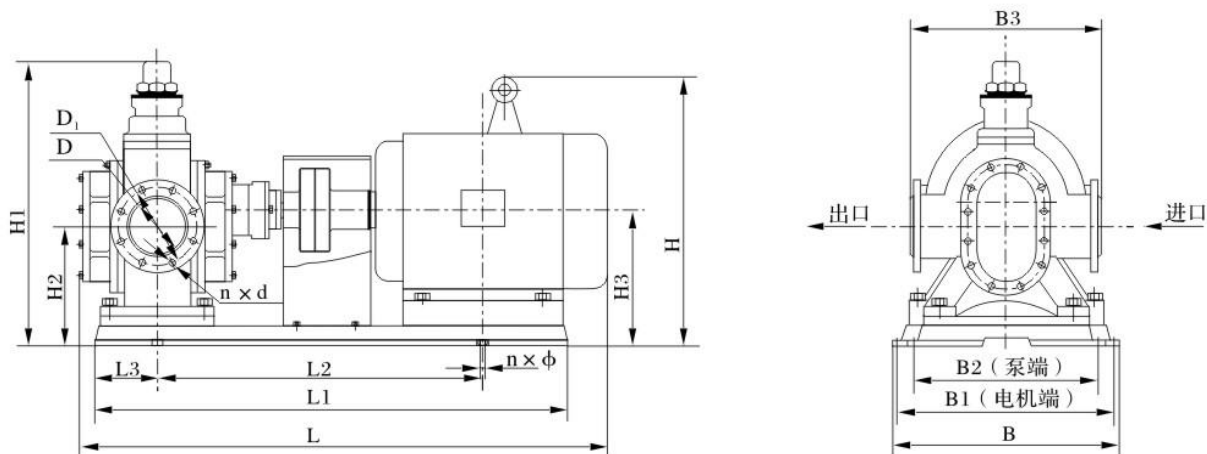

型号 Model	L	L ₁	L ₂	L ₃	H	H ₁	H ₂	H ₃	B	B ₁	B ₂	B ₃	D	D ₁	n × d	n × φ
KCB1200/0.6	1771	1470	990	194	780	828	340	420	683	631	621	510	φ150	φ225	8 × φ18	4 × φ25
KCB1600/0.6																
KCB1800/0.6	2036	1704	1142	230	1020	996	382	470	772	720	720	684	φ200	φ280	8 × φ18	4 × φ25
KCB2500/0.6																
KCB2850/0.6	2294	1880	1250	270	1070	1035	419	520	810	750	750	640	φ250	φ335	12 × φ18	4 × φ30
KCB3800/0.6																
KCB4100/0.6	2524	2008	1340	270	1200	1035	419	520	1163	906	750	640	φ250	φ335	12 × φ18	4 × φ30
KCB5400/0.6																

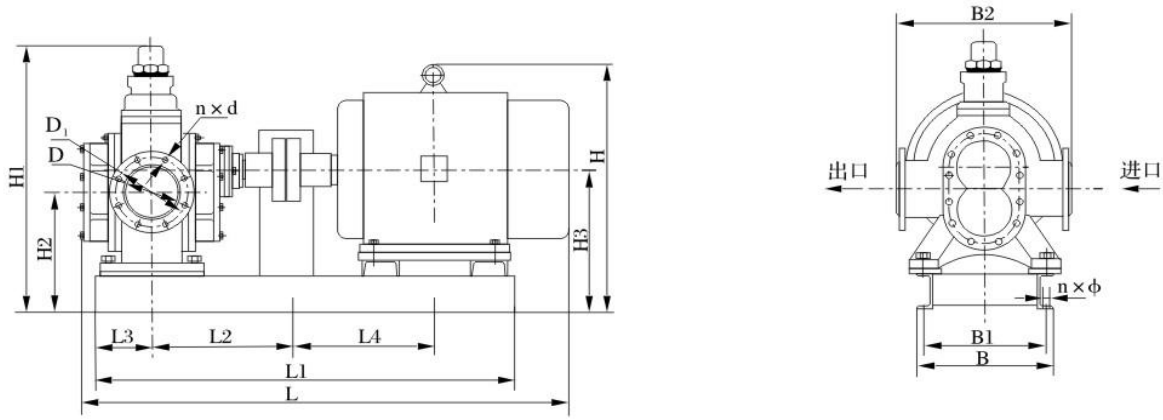

型号 Model	L	L ₁	L ₂	L ₃	L ₄	H	H ₁	H ₂	H ₃	B	B ₁	B ₂	D	D ₁	n × d	n × φ
KCB5600	2632	2090	723	245	723	1465	1440	671	785	760	690	740	φ350	φ445	12 × φ23	6 × φ32
KCB7000	2662	2090	723	245	723	1465	1440	671	785	760	690	740	φ350	φ445	12 × φ23	6 × φ32
KCB7600	2632	2090	723	245	723	1465	1440	671	785	760	690	740	φ350	φ445	12 × φ23	6 × φ32
KCB9600	2662	2090	723	245	723	1465	1440	671	785	760	690	740	φ350	φ445	12 × φ23	6 × φ32

YCB型整机外形、安装尺寸及重量

YCB TYPE GEAR PUMP OUTLINE INSTALLATION DIMENSION & WEIGHT

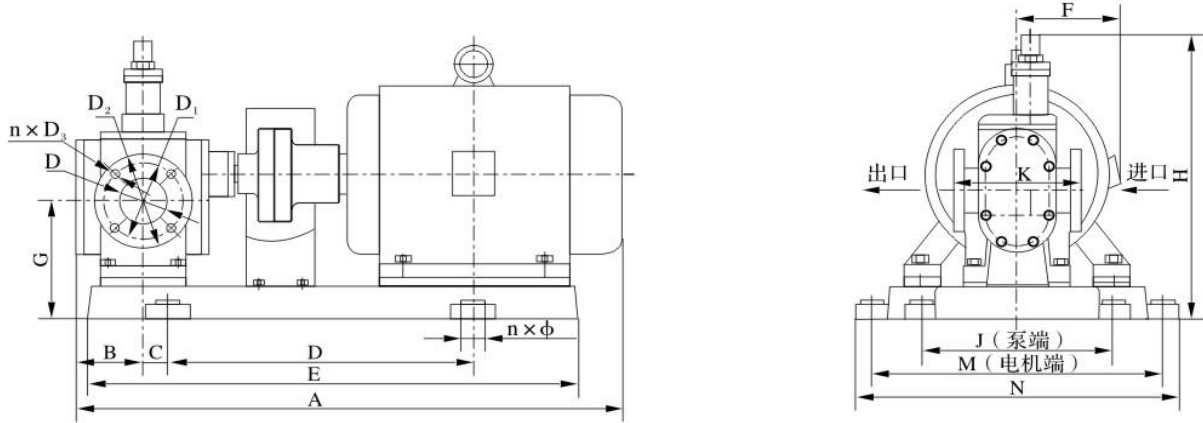

型号 Model	流量 Capacity m ³ /h	A	B	C	D	E	F	G	H	J	K	M	N	D	D ₁	D ₂	n × D ₃	n × φ	重量 Weight(kg)				
YCB0.6-0.6	0.6	506	50	22.5	280	421	155	115	232	136	125	222	252	φ25	φ75	φ100	4 × M10	4 × φ14	38.5				
YCB1.0-0.6	1.0	486.5			264	405	150		217			207	237										
YCB1.6-0.6	1.6	547	63	27.5	303	455	155		243			156	150							222	252	φ32	φ90
YCB2.5-0.6	2.5	644	76	35	344.5	544.5	180	122.6	298	198	180	266	298	φ40	φ100	φ130	4 × φ14	4 × φ16	65				
YCB3.3-0.6	3.3											303	455							155	243	156	150
YCB5.0-0.6	5.0	667.5	82	40	346	557						127.6	256							288	φ50	φ110	φ140
YCB8.0-0.6	8.0	795	101	50	382	644	210	140	396	218	220	332	364	φ65	φ130	φ160	4 × φ14	4 × φ16	117				
YCB12-0.6	12	849	430		690																		
YCB10-0.6	10	808	392		652																		
YCB15-0.6	15	1009	131.5	29.5	566	845	255	165.8	471.5	270	260	380	416	φ80	φ150	φ190	4 × φ18	4 × φ18	216				
YCB20-0.6	20	1100	146.5		603	904						385	421							φ100	φ170	φ210	223
YCB25-0.6	25	1125	147		35	646						954	196							517	295	275	400
YCB30-0.6	30	1214	161	42.5	673	1023	285	212	562	315	300	425	461	φ125	φ200	φ240	8 × φ18	4 × φ18	364				
YCB40-0.6	40	1300	159	52.5	680	1080	310	237	590	340	300	476	536	φ125	φ200	φ240	8 × φ18	4 × φ22					

注意事项

- 1、严禁泵腔内无液空转；
- 2、检查电机转向是否正确，严禁长时间倒转；
- 3、禁止泵在汽蚀状态下长期运行；
- 4、进水管必须严格密封不得漏水、漏气；
- 5、严禁在低扬程、大流量工况下电机长时间超负荷运行。